

SIM7500-PCIE Series

SIMCom LTE Cat 1 Module

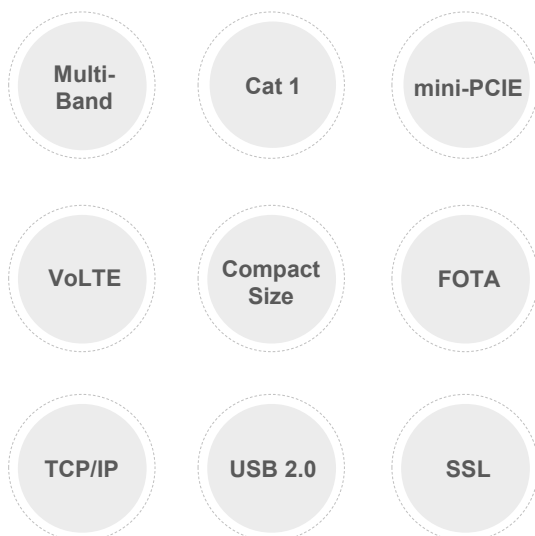
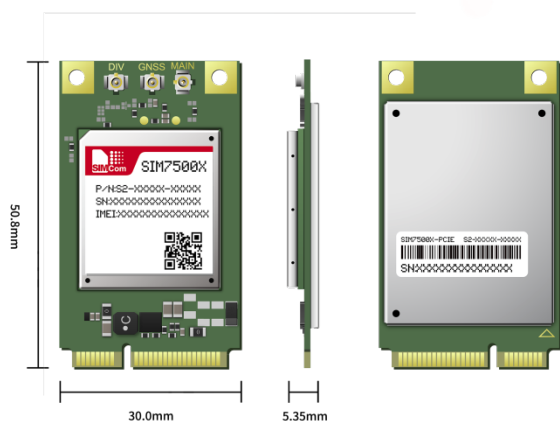

Product Description

The SIM7500-PCIE series is the LTE Cat 1 module which supports wireless communication modes of LTE-TDD/ LTE-FDD/HSPA+/GSM/GPRS/EDGE etc. It supports maximum 10Mbps downlink rate and 5Mbps uplink rate.

The SIM7500-PCIE series adopts mini PCIE form factor and consists of a SIM7500 series module and a mini PCIE adapter board. It is easy for customers to integrate.

The SIM7500-PCIE series integrates multiple satellite high accuracy positioning GNSS systems, with multiple built-in network protocols, supports drivers for main operation systems (USB driver for Windows, Linux and Android etc.) and software function, AT commands are compatible with SIM7600/SIM7600-H series modules. Meanwhile the SIM7500-PCIE series integrates main industrial standard interfaces, with powerful expansibility, including abundant interfaces such as UART, USB, GPIO, which is suitable for main IoT applications such as telematics, surveillance devices, CPE, industrial routers, and remote diagnostics etc.

Key Benefits

- ◆ Mini-PCIE interface with strong compatibility
- ◆ Suitable for LTE, UMTS and GSM networks with global coverage
- ◆ Abundant software functions: FOTA, LBS, TLS, VoLTE
- ◆ Multi-constellation GNSS receiver support
- ◆ AT commands of the SIM7500-PCIE series are compatible with the SIM7600/SIM7600-H series modules

| Product | | SIM7500A-PCIE | SIM7500AD-PCIE | SIM7500V-PCIE | SIM7500SA-PCIE |
|----------------------------|--------------|--|--|--|--|
| Form Factor | | Mini PCIE | Mini PCIE | Mini PCIE | Mini PCIE |
| Dimensions(mm) | | 50.8*30*5.35 | 50.8*30*5.35 | 50.8*30*5.35 | 50.8*30*5.35 |
| Frequency | LTE-FDD | B2/B4/B12 | B2/B4/B12 | B4/B13 | B1/B3/B5/B7/B8/B28 |
| Bands | WCDMA | B2/B5 | B2/B5 | | B1/B5 |
| GNSS | | o | o | o | o |
| Temperature | | -40℃ ~ +85℃ | -40℃ ~ +85℃ | -40℃ ~ +85℃ | -40℃ ~ +85℃ |
| Electrical Features | | | | | |
| Supply Voltage(V) | | 3.0~ 3.6 | 3.0~ 3.6 | 3.0~ 3.6 | 3.0~ 3.6 |
| Power Consumption (mA) | LTE | 1.6 | 1.6 | 1.6 | 1.6 |
| | WCDMA, DRX=9 | 3.3 | 3.3 | 3.3 | 3.3 |
| Data Transfer | | | | | |
| LTE(Mbps) | | 10(DL)/5(UL) | 10(DL)/5(UL) | 10(DL)/5(UL) | 10(DL)/5(UL) |
| HSPA+(Mbps) | | 42(DL)/5.76(UL) | 42(DL)/5.76(UL) | | 42(DL)/5.76(UL) |
| WCDMA(Kbps) | | 384(DL)/384(UL) | 384(DL)/384(UL) | | 384(DL)/384(UL) |
| Software Features | | | | | |
| Protocol | | TCP/IP/IPV4/IPV6/ Multi-PDP/FTP/FTPS/ HTTP/HTTPS/DNS | TCP/IP/IPV4/IPV6/ Multi-PDP/FTP/FTPS/ HTTP/HTTPS/DNS | TCP/IP/IPV4/IPV6/ Multi-PDP/FTP/FTPS/ HTTP/HTTPS/DNS | TCP/IP/IPV4/IPV6/ Multi-PDP/FTP/FTPS/HTTP/ HTTPS/DNS |
| TLS | | • | • | • | • |
| File System | | • | • | • | • |
| Audio Record/Play | | o | | o | o |
| TTS | | o | | o | o |
| DTMF | | o | | o | o |
| LBS | | • | • | • | • |
| FOTA | | • | • | • | • |
| Jamming Detection | | • | • | • | • |
| Android RIL | | Android 5.0/6.0/7.0/8.0/9.0 | Android 5.0/6.0/7.0/8.0/9.0 | Android 5.0/6.0/7.0/8.0/9.0 | Android 5.0/6.0/7.0/8.0/9.0 |
| USB Driver | | Microsoft Windows 7/8/10 Linux/Android | Microsoft Windows 7/8/10 Linux/Android | Microsoft Windows 7/8/10 Linux/Android | Microsoft Windows 7/8/10 Linux/Android |
| WWAN (RNDIS) | | • | • | • | • |
| ECM | | • | • | • | • |
| MBIM | | Win8/Win10 | Win8/Win10 | Win8/Win10 | Win8/Win10 |
| NDIS | | Linux/Windows 7/8/10 | Linux/Windows 7/8/10 | Linux/Windows 7/8/10 | Linux/Windows 7/8/10 |
| Firmware Upgrade | | USB/FOTA | USB/FOTA | USB/FOTA | USB |
| Interfaces | | | | | |
| SIM Card | | 1.8V/3.0V | 1.8V/3.0V | 1.8V/3.0V | 1.8V/3.0V |
| UART | | • | • | • | • |
| USB | | • | • | • | • |
| PCM | | o | | o | o |
| Analog Audio | | o | | o | o |
| Embedded SIM card socket | | o | o | o | o |
| I2C | | • | • | • | • |
| Diversity Receiver | | • | • | • | • |
| Certification | | | | | |
| Regulatory | | FCC/IC/PTCRB/RoHS/REACH | FCC/PTCRB/RoHS/REACH | FCC/GCF/RoHS/REACH | CE-RED/ACMA/NCC/RoHS/REACH |
| Carrier | | AT&T/Rogers | T-Mobile | Verizon | |

•: support o: optional *: on going

| Product | SIM7500E-PCIE | SIM7500E-L1C-PCIE | SIM7500JC-PCIE | SIM7500JE-PCIE |
|---------------------------------|--|--|--|--|
| Form Factor | Mini PCIE | Mini PCIE | Mini PCIE | Mini PCIE |
| Dimensions(mm) | 50.8*30*5.35 | 50.8*30*5.35 | 50.8*30*5.35 | 50.8*30*5.35 |
| Frequency Bands | LTE-FDD | B1/B3/B7/B8/B20 | B1/B3/B7/B8/B20 | B1/B3/B8 |
| | WCDMA | B1/B8 | B1/B8 | |
| | GSM | 900/1800MHz | 900/1800MHz | |
| GNSS | o | o | o | o |
| Temperature | -40°C ~ +85°C | -40°C ~ +85°C | -40°C ~ +85°C | -40°C ~ +85°C |
| Electrical Features | | | | |
| Supply Voltage(V) | 3.4~ 4.2 | 3.4~ 4.2 | 3.4~ 4.2 | 3.4~ 4.2 |
| Power Consumption (mA) | LTE | 1.6 | 1.6 | 1.6 |
| | WCDMA, DRX=9 | 3.3 | 3.3 | |
| | GSM, BS_PA_MFRMS=2 | 2.8 | 2.8 | |
| Data Transfer | | | | |
| LTE(Mbps) | 10(DL)/5(UL) | 10(DL)/5(UL) | 10(DL)/5(UL) | 10(DL)/5(UL) |
| HSPA+(Mbps) | 42(DL)/5.76(UL) | 42(DL)/5.76(UL) | | |
| WCDMA(Kbps) | 384(DL)/384(UL) | 384(DL)/384(UL) | | |
| GPRS/EDGE(Kbps) | 236.8(DL)/236.8(UL) | 236.8(DL)/236.8(UL) | | |
| Software Features | | | | |
| Protocol | TCP/IP/IPV4/IPV6/ Multi-PDP/FTP/FTPS/HTTP/ HTTPS/DNS | TCP/IP/IPV4/IPV6/ Multi-PDP/FTP/FTPS/HTTP/ HTTPS/DNS | TCP/IP/IPV4/IPV6/ Multi-PDP/FTP/FTPS/ HTTP/HTTPS/DNS | TCP/IP/IPV4/IPV6/ Multi-PDP/FTP/FTPS/ HTTP/HTTPS/DNS |
| TLS | • | • | • | • |
| File System | • | • | • | • |
| Audio Record/Play | o | o | o | o |
| TTS | o | o | o | o |
| DTMF | o | o | o | o |
| LBS | • | • | • | • |
| FOTA | • | | • | • |
| Jamming Detection | • | • | • | • |
| Android RIL | Android 5.0/6.0/7.0/8.0/9.0 | Android 5.0/6.0/7.0/8.0/9.0 | Android 5.0/6.0/7.0/8.0/9.0 | Android 5.0/6.0/7.0/8.0/9.0 |
| USB Driver | Microsoft Windows 7/8/10 Linux/Android | Microsoft Windows 7/8/10 Linux/Android | Microsoft Windows 7/8/10 Linux/Android | Microsoft Windows 7/8/10 Linux/Android |
| WWAN (RNDIS) | • | • | • | • |
| ECM | • | • | • | • |
| MBIM | Win8/Win10 | Win8/Win10 | Win8/Win10 | Win8/Win10 |
| NDIS | Linux/Windows 7/8/10 | Linux/Windows 7/8/10 | Linux/Windows 7/8/10 | Linux/Windows 7/8/10 |
| Firmware Upgrade | USB/FOTA | USB | USB/FOTA | USB/FOTA |
| Interfaces | | | | |
| SIM Card | 1.8V/3.0V | 1.8V/3.0V | 1.8V/3.0V | 1.8V/3.0V |
| UART | • | • | • | • |
| USB | • | • | • | • |
| PCM | o | o | o | o |
| Analog Audio | o | o | o | o |
| Embedded SIM card socket | o | o | o | o |
| I2C | • | • | • | • |
| Diversity Receiver | • | | • | • |
| Certification | | | | |
| Regulatory | CE-RED/ACMA/NCC/RoHS/ REACH | CE-RED*/RoHS*/REACH* | Telec/JATE/RoHS/REACH | Telec/JATE/RoHS/REACH |
| Carrier | | | | Softbank |

• : support o : optional * : on going